

vtech[®]

User's Manual

Toot-Toot Animals

Pet Playground



© 2016 VTech
All rights reserved
Printed in China

91-003309-001 

VTech understands that a child's needs and abilities change as they grow and with that in mind we develop our toys to teach and entertain at just the right level...

vtech Baby

Toys that will stimulate their interest in different textures, sounds and colours

I am...

...responding to colours, sounds and textures

...understanding cause and effect

...learning to touch, reach, grasp, sit-up, crawl and toddle

Birth-36 months



Pre-School

Interactive toys to develop their imagination and encourage language development

I want...

...to get ready for school by starting to learn the alphabet and counting

...my learning to be as fun, easy and exciting as can be

...to show my creativity with drawing and music so my whole brain develops

3-6 years



Electronic Learning Computers

Cool, aspirational and inspiring computers for curriculum related learning

I need...

...challenging activities that can keep pace with my growing mind

...intelligent technology that adapts to my level of learning

...National Curriculum based content to support what I'm learning at school

4-10 years



To learn more about this and other VTech® products, visit www.vtech.co.uk

INTRODUCTION

Thank you for purchasing the **VTech® Toot-Toot Animals Pet Playground!**

Explore the **Toot-Toot Animals Pet Playground** by **VTech®**. Learn about the squirrel, its colour and more with the **SmartPoint™** squirrel. Then, lift the platform to launch the squirrel down the slide. For added fun, you can connect this play set to other **Toot-Toot Animals** play sets (each sold separately).

**3 SMARTPOINT™
LOCATIONS**

LAUNCHER

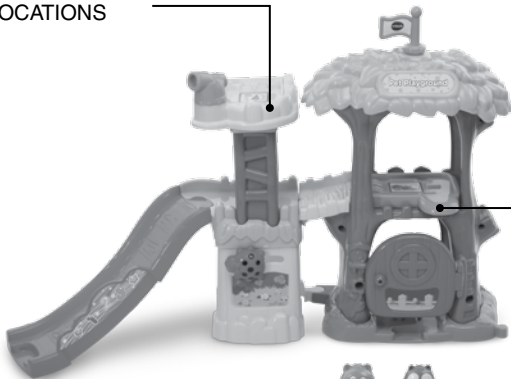

**LIGHT UP
BUTTON**

**SMARTPOINT™
SQUIRREL**



ROLY-POLY ANIMALS

INCLUDED IN THIS PACKAGE



SmartPoint™
squirrel



Tree house



One flag

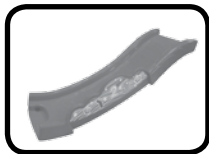

Slide track



One squirrel



One husky dog



User's manual

Unlock the packaging lock:

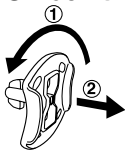

- ① Rotate the packaging lock anticlockwise 90 degrees.
- ② Pull out and discard the packaging lock.

WARNING: All packing materials, such as tape, plastic sheets, packaging locks and tags are not part of this toy, and should be discarded for your child's safety.

NOTE: Please keep this user's manual as it contains important information.

GETTING STARTED

BATTERY INSTALLATION - SQUIRREL

1. Make sure the unit is turned **OFF**.
2. Locate the battery cover on the bottom of the squirrel. Use a coin or a screwdriver to loosen the screw.
3. Install two new AAA (AM-4/LR03) batteries following the diagram inside the battery box. (The use of new alkaline batteries is recommended for maximum performance).
4. Replace the battery cover and tighten the screw to secure.

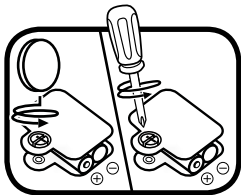

BATTERY NOTICE

- Use new alkaline batteries or fully charged NI-MH (Nickel Metal-hydride) rechargeable batteries for best performance.
- Use only batteries of the same or equivalent type as recommended.
- Do not mix different types of batteries: alkaline, standard (carbon-zinc) or rechargeable (Ni-Cd, Ni-MH), or new and used batteries.
- Do not use damaged batteries.
- Insert batteries with the correct polarity.
- Do not short-circuit the battery terminals.
- Remove exhausted batteries from the toy.
- Remove batteries during long periods of non-use.
- Do not dispose of batteries in fire.

- Do not charge non-rechargeable batteries.
- Remove rechargeable batteries from the toy before charging (if removable).
- Rechargeable batteries are only to be charged under adult supervision.

Disposal of batteries and product



The crossed-out wheellie bin symbols on products and batteries, or on their respective packaging, indicates they must not be disposed of in domestic waste as they contain substances that can be damaging to the environment and human health.



The chemical symbols Hg, Cd or Pb, where marked, indicate that the battery contains more than the specified value of mercury (Hg), cadmium (Cd) or lead (Pb) set out in Battery Directive (2006/66/EC).



The solid bar indicates that the product was placed on the market after 13th August, 2005.

Help protect the environment by disposing of your product or batteries responsibly.

For more information, please visit:

www.recycle-more.co.uk

www.recyclenow.com

ASSEMBLY INSTRUCTIONS

With the **VTech® Toot-Toot Animals Pet Playground**, safety comes first. To ensure your child's safety, adult assembly is required.

1. Insert the **FLAG** into the top of the **TREE HOUSE**. You will hear a “click” sound to indicate the **FLAG** is secure.

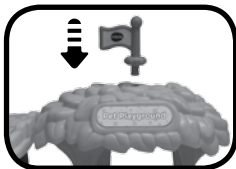

2. Attach the **SLIDE TRACK** to the **TREE HOUSE**.

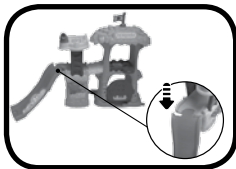

PRODUCT FEATURES - SQUIRREL

1. ON/OFF SWITCH

To turn the unit **ON**, slide the **ON/OFF SWITCH** to the **ON** (⏻) position. To turn the unit **OFF**, slide the **ON/OFF SWITCH** to the **OFF** (●) position.

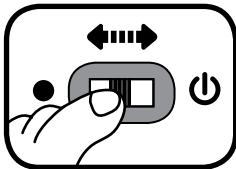

2. AUTOMATIC SHUT OFF

To preserve battery life, the unit will automatically power-down after approximately 30 seconds without input. The unit only can be turned on again by pressing the **LIGHT UP BUTTON** or by pushing the squirrel quickly.

Note: This product is in **TRY ME** mode in the packaging. After opening the package, turn the animal **OFF** and **ON** again to proceed with normal play. If the unit powers down while playing, we suggest changing the batteries.

ACTIVITIES - SQUIRREL

1. Slide the **ON/OFF SWITCH** to the **ON** () position to turn the unit **ON**. You will hear sounds, a song and a phrase. The light will flash with the sounds.

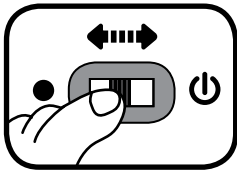

2. Press the **LIGHT UP BUTTON** to hear fun sounds, songs and phrases. The light will flash with the sounds.



3. Push the squirrel to hear fun sounds and melodies. While a melody is playing, push the squirrel again to add fun sounds on top of the melody. The light will flash with the sounds.



4. For added fun, the squirrel interacts with the **VTech® Toot-Toot Animals Pet Playground**. Simply place the squirrel on one of the play sets **SmartPoint™** locations to see the light flash and to hear greetings, fun sounds, short tunes and phrases. You can also play with your animal on other **Toot-Toot Animals** play sets (each sold separately).



PRODUCT FEATURES – PET PLAYGROUND

1. SMARTPOINT™ LOCATIONS

The **Pet Playground** includes three **SmartPoint™** locations that interact with the included **SmartPoint™** squirrel or other **Toot-Toot Animals** characters (each sold separately). Simply place the animal on a **SmartPoint™** location to hear fun sounds, phrases and music.

ACTIVITIES

1. Place the squirrel on the **LAUNCHER**. Then lift the **LAUNCHER** to watch the squirrel race down the **SLIDE TRACK**.

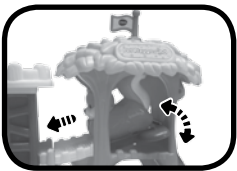

2. Place the squirrel on the **TELESCOPE** platform to trigger a fun response. Twist the **TELESCOPE** for mechanical play.



3. Move the ladybird back and forth for added pretend play.



4. Open and close the **DOOR** to let the squirrel in and out of the house. Placing the squirrel on the **TREE SMARTPOINT™** will trigger responses.



CARE & MAINTENANCE

1. Keep the unit clean by wiping it with a slightly damp cloth.
2. Keep the unit out of direct sunlight and away from any direct heat source.
3. Remove the batteries when the unit will not be in use for an extended period of time.
4. Do not drop the unit on hard surfaces and do not expose the unit to moisture or water.

TROUBLESHOOTING

If for some reason the unit stops working, please follow these steps:

1. Please turn the unit **OFF**.
2. Interrupt the power supply by removing the batteries.
3. Let the unit stand for a few minutes, then replace the batteries.
4. Turn the unit **ON**. The unit should now be ready to play again.
5. If the product still does not work, install a new set of batteries.

If the problem persists, please call our Consumer Services Department on 01235 546810 (from UK) or +44 1235 546810 (outside UK) and a service representative will be happy to help you.

IMPORTANT NOTE:

Creating and developing **VTech®** products is accompanied by a responsibility that we take very seriously. We make every effort to ensure the accuracy of the information, which forms the value of our products. However, errors sometimes can occur. It is important for you to know that we stand behind our products and encourage you to call our Consumer Services Department on 01235 546810 (from UK) or +44 1235 546810 (outside UK), with any problems and/or suggestions that you might have. A service representative will be happy to help you.

CLASS 1
LED PRODUCT



PRODUCT REGISTRATION

Visit www.vtech.co.uk/clubvtech/login
to register your VTech product

By joining the VTech Club you can also enter competitions, find out about news and events, seek expert advice for parents and let your kids play fun learning games and activities.



PRODUCT WARRANTY

Thank you for choosing this quality product from VTech. We hope it will bring many hours of entertainment, imaginative play and learning.

1. The product detailed above is covered by a one year warranty from the date of purchase, against any defects in materials or workmanship.
2. The product may be returned to the place of purchase. Alternatively the product can be returned to VTech Electronics Europe plc (see address below), with proof of purchase, without proof of purchase no replacement will be provided.
3. VTech Electronics Europe plc will examine the product and if it is found to be defective due to faulty materials or workmanship, will replace the product at their discretion.
4. If the product covered by this warranty is damaged due to misuse, modification or unauthorised repair, or because of faulty batteries, battery discharge or incorrect electrical connections, then this warranty becomes void.
5. This warranty is personal to the original purchaser and is not transferable.
6. Breakages to the LCD screen are not covered by the warranty.
7. Returns to VTech Electronics Europe plc should include a cheque or postal order for £1.50 towards the cost of return postage and packaging.
8. Products returned to VTech Electronics Europe plc, should be addressed as follows and packed carefully to avoid damage in transit (Please do not include batteries or adaptor). Please include details of the fault together with your name and address.
9. To keep an online record of your warranty, please register your product online at www.vtech.co.uk/warranty

Vtech Electronics EU PLC, c/o XPO Logistics, Warehouse 350, Cat & Fiddle Lane, West Hallam, DE7 6HE

THIS WARRANTY IS OFFERED AS AN EXTRA BENEFIT AND DOES NOT AFFECT CONSUMERS' STATUTORY RIGHTS.

This warranty is valid for the UK and Eire only. For products purchased outside the UK and Eire, please contact your local distributor or place of purchase.